

# PURKEYS

## AWARE™

---

# INSTALLATION GUIDE





# CONTENTS

---

General Information .....	2
AWARE Installation .....	3
Enabling the Wireless Connection .....	4
Pairing with the AWARE .....	5
Setting the Sound Settings .....	6
Limited Commercial Warranty Policy.....	8

## GENERAL INFORMATION

The AWARE™ is an audio interface management system that integrates with the speaker system of a truck and routes messages from a telematics alert system, a cell phone, or other device with wireless connectivity, through the speakers.

The AWARE also allows for optional microphone connection for hands-free use (mic sold separately).

Note: The images included in this guide are general examples only; your specific device may vary slightly.

# AWARE INSTALLATION GUIDE

## AWARE INSTALLATION

---

Step 1: Turn the truck off. This device is best installed in a powered-down environment.

Step 2: Remove the radio, following your truck manufacturer's recommended procedure.

Step 3: Unplug the truck wiring harness from the radio.



Step 4: Plug the AWARE harness into the radio.



Step 5: Plug the truck wiring harness into the back of the AWARE.



Step 6: Slide the radio back into place with the AWARE behind it.



## Enabling the Wireless Connection

Step 1: Go to the telematic tablet settings and turn on the Bluetooth setting.

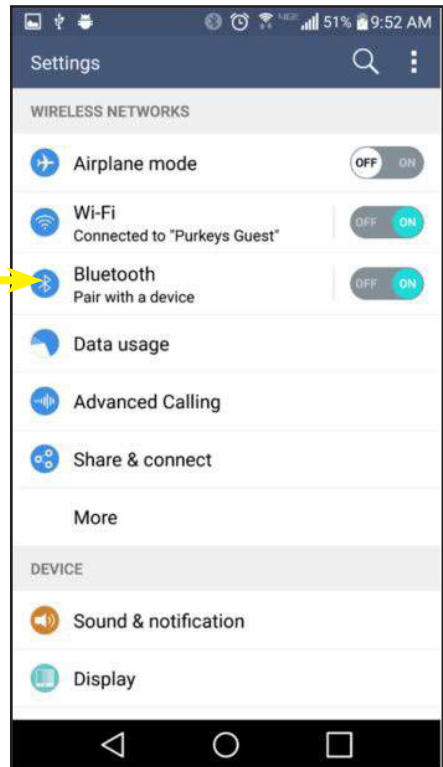
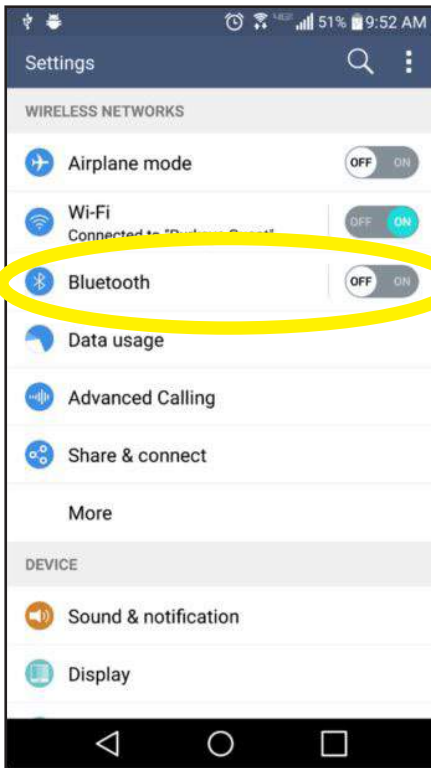

# AWARE INSTALLATION GUIDE

## Pairing with the AWARE

Step 1: A list of all bluetooth paired devices will appear when you turn on the Bluetooth setting.

The AWARE will show up in “Available Devices.” Touch the AWARE icon and the device will pair with the AWARE.

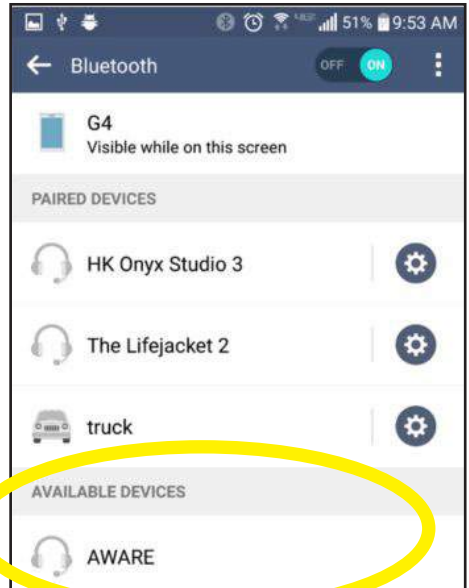

Step 2: Once connected, your AWARE will appear in the paired devices list and should read “Connected to call and media audio.”

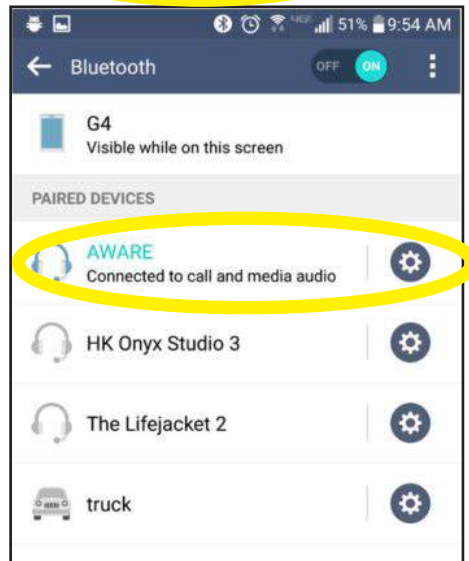

## Setting the Sound Settings

Purkeys recommends that all sound effects be turned off.

Step 1: Go to settings, sound and notifications, sound effects.

Step 2: Turn off all unnecessary sounds, as they will come through the truck speakers (though vibrate will not) and may become irritating.

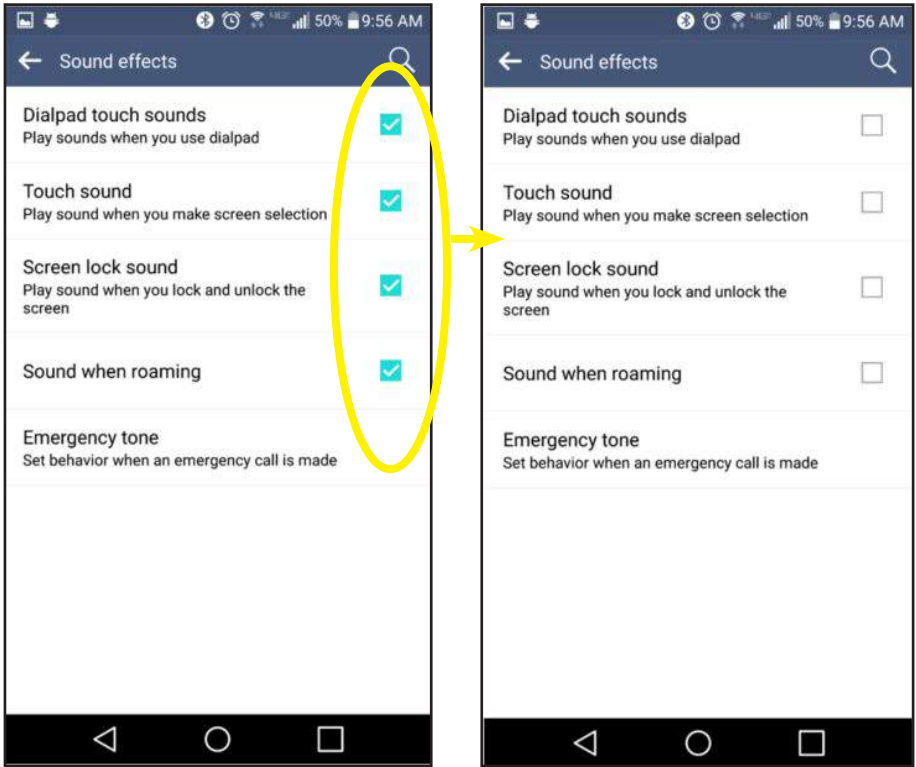

Step 3: Go to the telematic device's Bluetooth volume settings. Set the volume to maximum.



# AWARE INSTALLATION GUIDE

## NOTES

## LIMITED COMMERCIAL WARRANTY POLICY

---

Purkeys Fleet Electric, Inc. (hereafter “Purkeys”), warrants each product to be free of defects in material or workmanship under normal use and service. This warranty is for the benefit of Original Equipment Manufacturers, Dealers, Warehouse Distributors, Fleets, or other End Users (hereafter “Customers”) and covers products manufactured by Purkeys and sold new to Customers either directly by Purkeys or by its authorized dealers, distributors, or agents. The length of the Warranty Period is 36 months.

The warranty period commences on the in-service or install date and is not transferable. Failure to provide the in-service or install date on the warranty claim form will cause the warranty period to begin on the date the part was manufactured or date of sale recorded on the original sales invoice, whichever is earlier.

A completed warranty claim form should accompany all parts submitted to Purkeys for consideration for repair or replacement under warranty. The submitted claim form should contain all of the information required. Lack of a properly or fully completed claim form will result in delay or denial of warranty claim. Claims must be submitted no later than 30 days after part is removed.

This warranty does not apply if, in sole judgement of Purkeys, the product has been damaged or subjected to accident, faulty repair, improper adjustment, improper installation or wiring, neglect, misuse, or alteration or if the product failure is caused by defects in peripheral vehicle components or components attached to the Product or failure of a part not manufactured by Purkeys.

This warranty shall not apply if any Purkeys product is used for a purpose for which it is not designed or is in any way altered without the specific prior written consent of Purkeys. ANY Product alleged by a Customer to be defective must be inspected by Purkeys as a part of the warranty claims process in order to confirm that the part has failed as a result of a defect in material or workmanship.

Transportation for products and parts submitted to Purkeys for warranty consideration must be prepaid by Customer. Repaired or replaced products and or components will be returned to Customer pre-paid by Customer or “freight collect” to the address provided by Customer in the warranty claim form. No charge will be made for labor or material in effecting such repairs.

The Warranty provided by Purkeys hereunder is specifically limited to repair or replacement of the Product as Purkeys deems most appropriate in its sole discretion. Purkeys neither assumes nor authorizes any other person to assume on its behalf any other warranty or liabilities in connection with Purkeys products. The Warranty does not apply to fuses or other “consumable” or maintenance items which are or may be a part of any Purkeys product.

**THIS WARRANTY DOES NOT APPLY TO LOSS OF VEHICLE OR EQUIPMENT, LOSS OF TIME, INCONVENIENCE, OR OTHER INCIDENTAL OR CONSEQUENTIAL DAMAGES. PURKEYS SPECIFICALLY DISCLAIMS AND SHALL NOT BE LIABLE FOR INCIDENTAL OR CONSEQUENTIAL DAMAGES arising out of or from the use of Purkeys products by the Customer.**

**THIS LIMITED WARRANTY IS IN LIEU OF ALL OTHER WARRANTIES, INCLUDING COMMON LAW WARRANTIES OF FITNESS FOR A PARTICULAR PURPOSE, MERCHANTABILITY, AND ANY OTHER EXPRESS OR IMPLIED WARRANTIES. ALL OTHER SUCH WARRANTIES ARE SPECIFICALLY DISCLAIMED.**

This Limited Commercial Warranty supersedes all previous Warranty Policies issued by Purkeys and any of its suppliers.

# AWARE INSTALLATION GUIDE



***WATT Keeps You Trucking***