



DIRECT™ MAX

Liftgate Charging System with Nosebox

The DIRECT™ nosebox line combines all the best features of our original liftgate charging systems into a space-saving nosebox.

It also includes an interior light controller (harness sold separately) designed to turn the lights on inside a trailer and automatically shut them off either:

- via a timer
- if the liftgate batteries drop to a low state of charge.



Electrical Specifications:

	Min	Max
Operating Voltage	7 V	16 V
Operating Temperature	-40°C	85°C
Quiescent current		< 30 mA

Product Weights:

Nosebox/plate: approx. 6 lbs

Nosebox/plate/cables: approx. 18 lbs

See the following pages for drawings and diagrams.

Features:

- Saves space on front of trailer
- Combines liftgate charging system into nosebox
- Maximizes energy transfer from truck to liftgate batteries
- Maintains and protects batteries
- Maximizes battery life and reduces downtime
- Utilizes dual pole connection and voltage drop compensation to provide faster recharge
- Automatically chooses best charge source: aux, dual pole, or reefer (with optional reefer harness)
- Gives priority to the ABS by turning off within 1/20th of a second if the source voltage drops below 9.5 V
- Outputs a signal that can be connected to a telematics system (will alert if liftgate battery gets critically low)
- Replaceable receptacles in case of damage
- Easy to read LED indication
- Powers interior dome lights from the liftgate battery (optional harness required)
- Designed to meet SAE J1455
- Patented (patent #s 8,004,242 and 9,725,000)
- 3-year warranty



DIRECT™ MAX

Drawings and Diagrams

Dimensions:

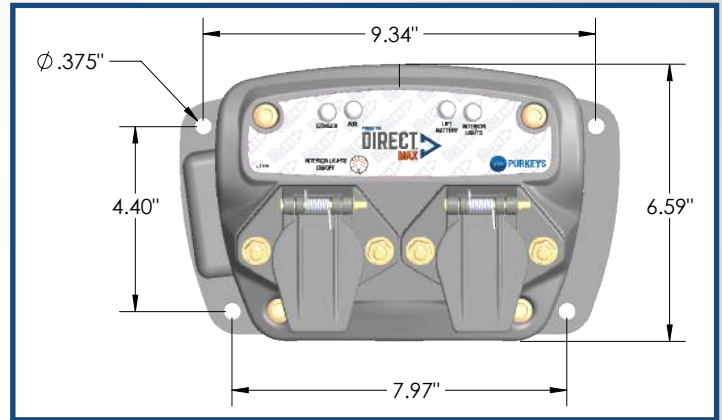
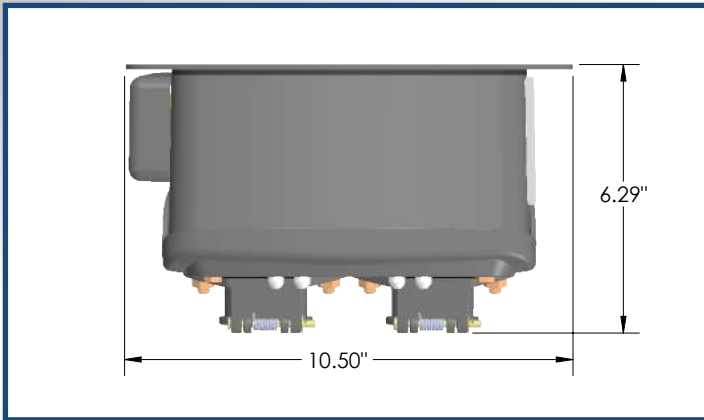

Note: nosebox without plate uses an industry standard bolt pattern.

Exterior Call-outs:

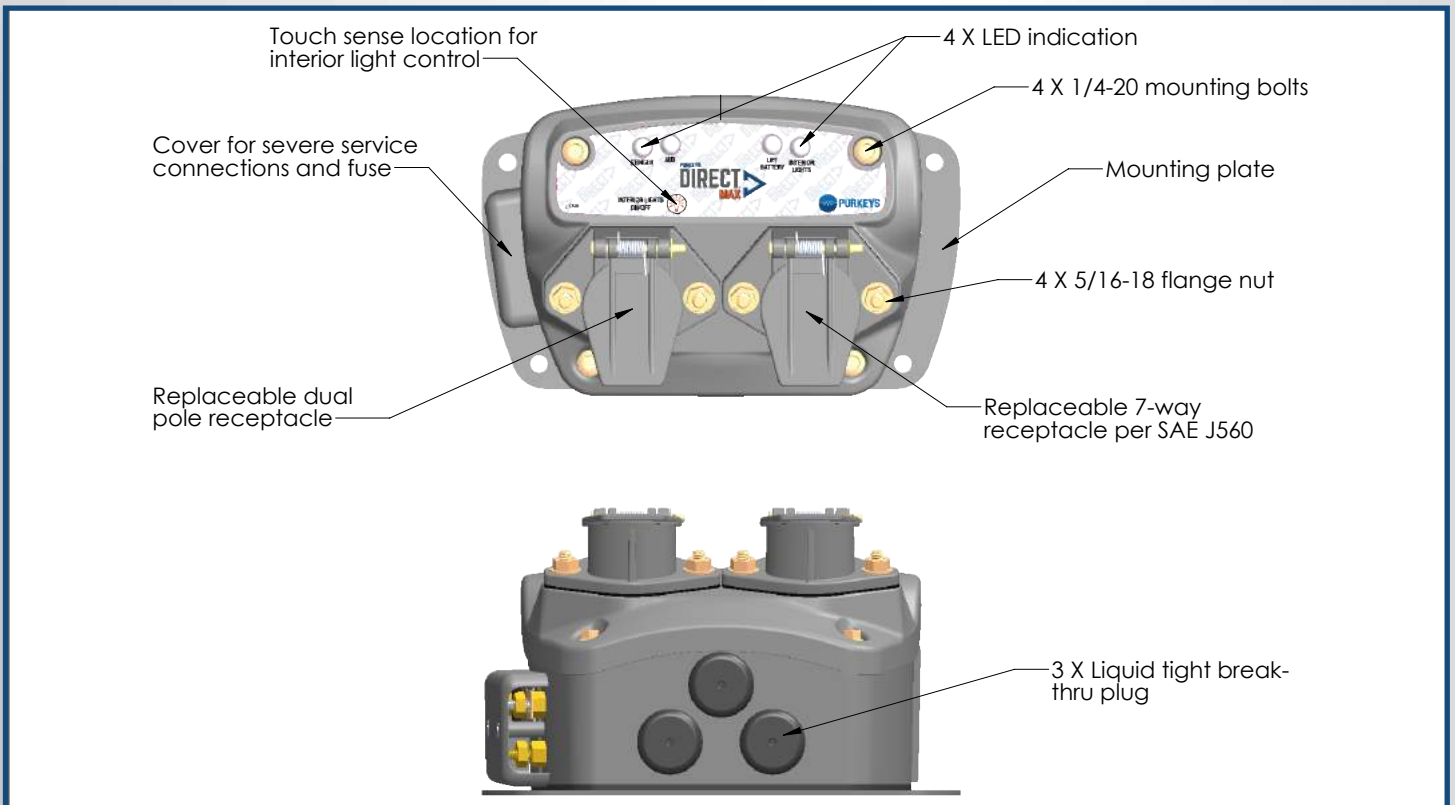



DIRECT™ MAX

Drawings and Diagrams

Severe Service Connections:

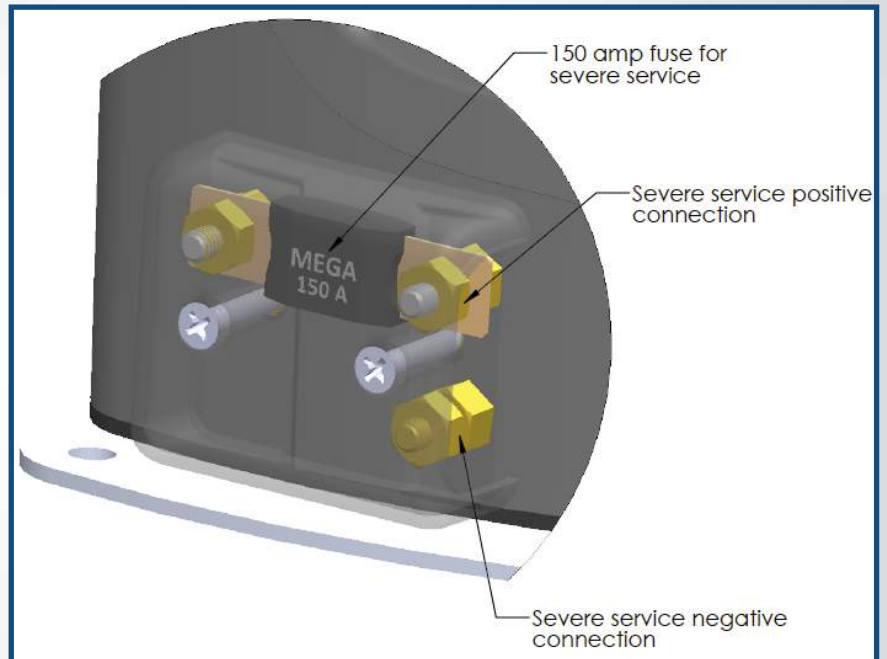
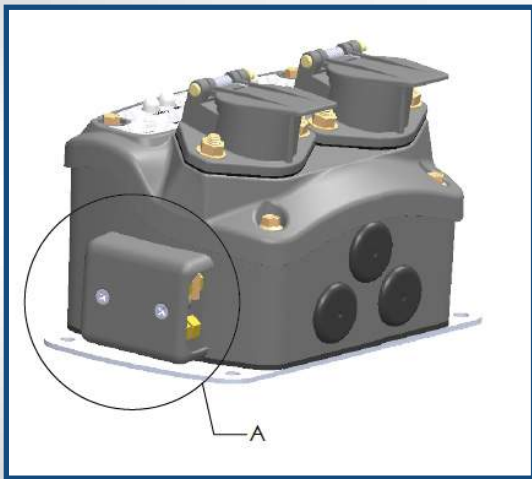

Lid:

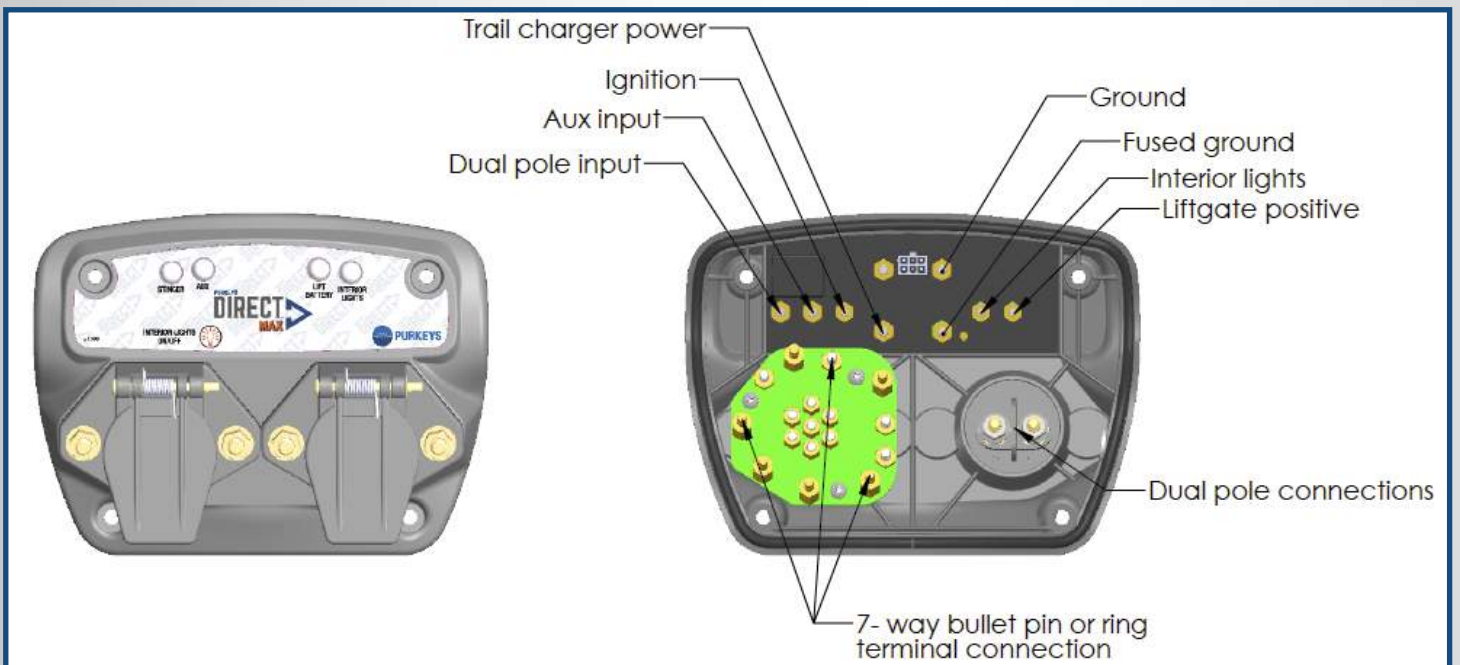



DIRECT™ MAX

Drawings and Diagrams

Electrical Diagram:

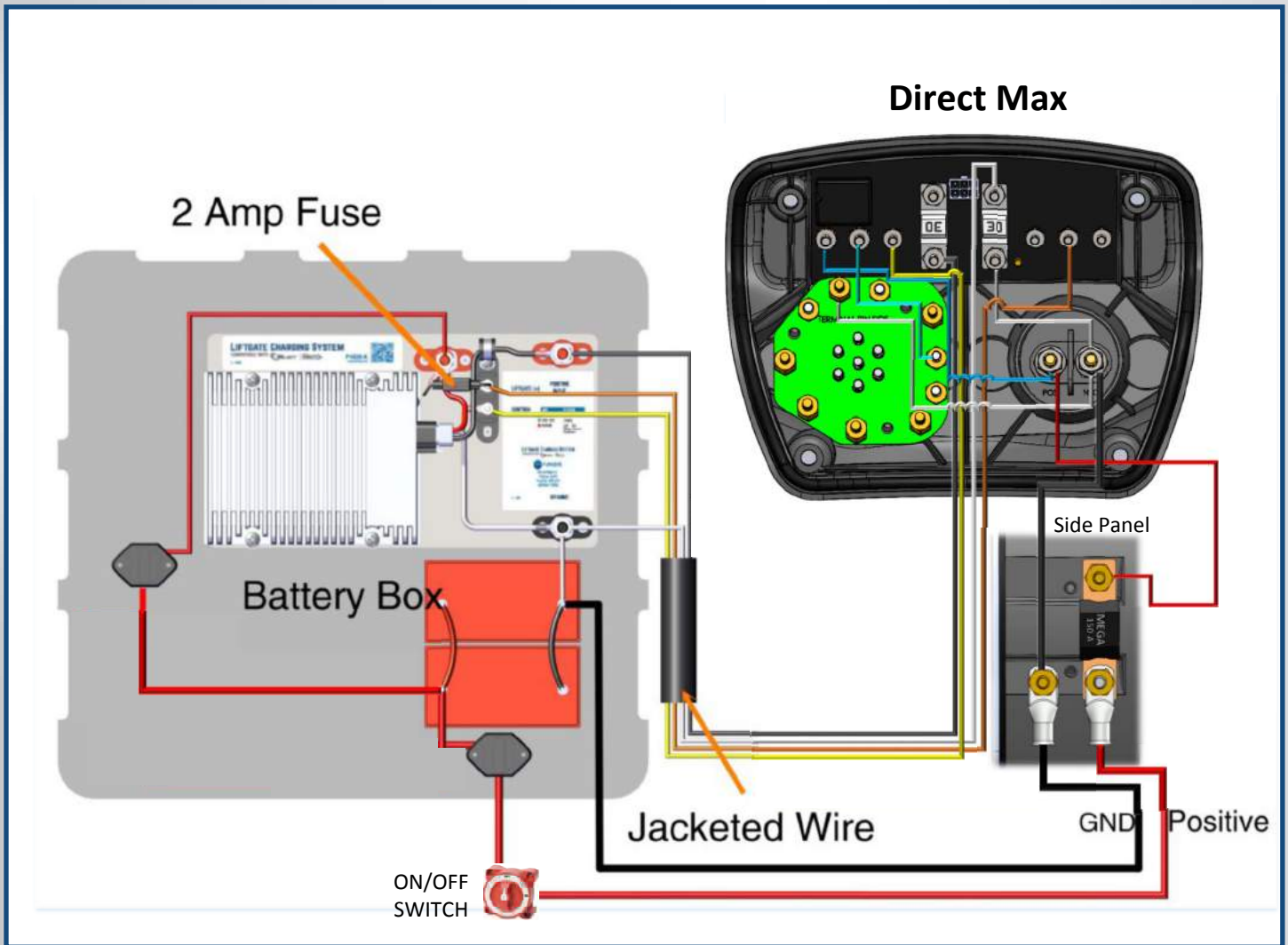



DIRECT™ MAX

Part Numbers and Cable Specifications

Part Numbers:

Part #	Output Harness Length	Includes DC/DC Converter?
MAX-25-A	25' ± 6"	NO
MAX-25-KIT	25' ± 6"	YES
MAX-50-A	50' ± 6"	NO
MAX-50-KIT	50' ± 6"	YES
MAX-70-A	70' ± 6"	NO
MAX-70-KIT	70' ± 6"	YES

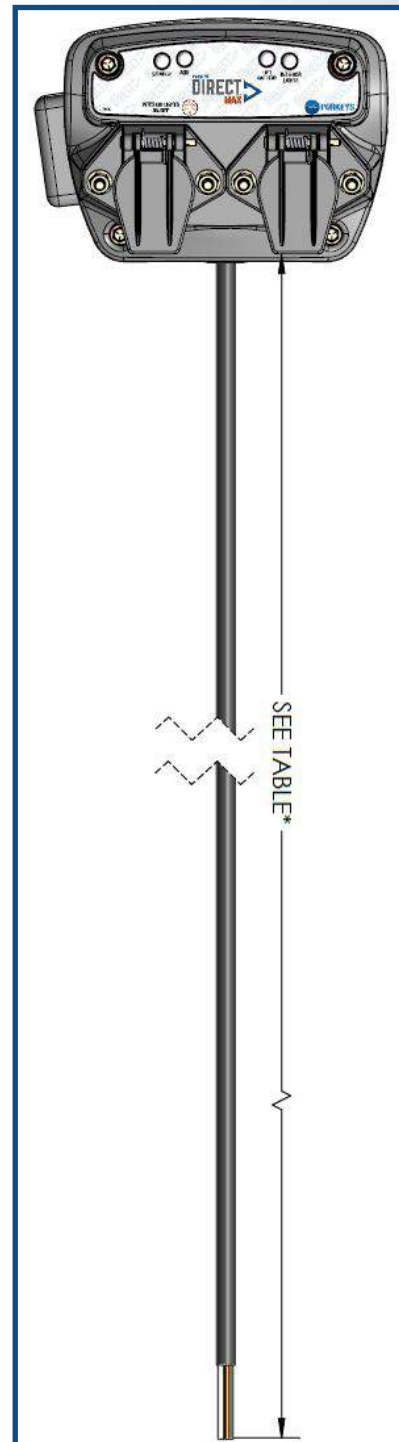

Cable Specifications (H-00286):

Gauge wire:	14 GA Orange 16 GA Yellow 8 GA Black 8 GA White
Overall O.D:	.490" O.D
Wall:	.030" ± .05
Stranding:	14 GA-19/27 16 GA 7/24 8 GA 19/21
Jacket Type:	+80° C and -30° C Black PVC
Wire insulation:	GXL



DIRECT™ MAX

Interior Light Controller and LED Logic

Interior Light Controller:

- Turn on/off from nosebox or from switch in trailer
- Turn off after timeout (includes settings for 15, 30, 60, and 90 minutes)
- Turn off after aux power goes from low to high
- Turn off if liftgate battery gets low (LVD)
- Blinks lights three times three minutes before turning off, two times two minutes before turning off, and once one minute before turning off



LED Logic:

LED	STATUS
Green solid	Charging
Green blink	Good voltage
Orange blink	Low voltage
Orange rapid-blink	Fault